

SMART HEAT DETECTION CAMERA

Heat detection / Push alarm / High-definition video / Smart search

WEBGATE
HD-CCTV solution provider

HD-SDI EX-SDI EX-SDI 2.0



Heat detection and CCTV surveillance at the same time!

HEAT DETECTION CAMERA with Full-HD CCTV monitoring,
The best optimized on thermosensitive device and facility

C1080BL-T2 / C1080PBL-T2
· 2.1M bullet camera
· LWIR sensor
· Embedded EX-SDI transmitter
· PoC/CoC : C1080PBL-T2

Camera can detect abnormal temperature and transmit push alarm for fire prevention!

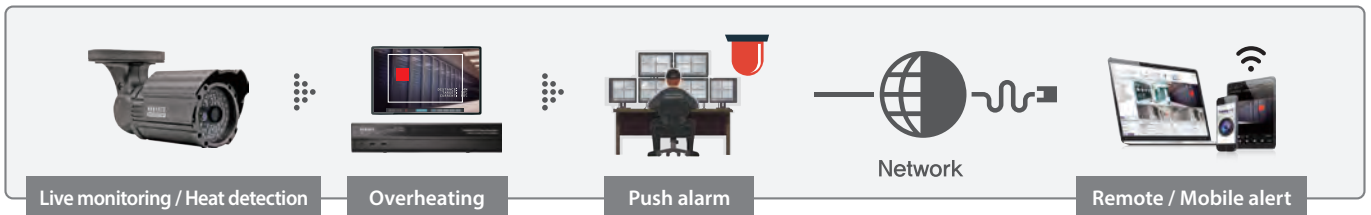

Applicable on thermosensitive device and facility!

- Prevention over fire or damage of facility hit by fire
- Efficient energy management led by detection of insulation
- Prevention of overheating on the farm or animals



Optimal setup for variable environment!



Configuration setup

The best optimized setup is enabled by detect distance, temperature setup menu



Alarm setup

Auto push alarm notice if target temperature is higher than preferable temperature



View angle setup

User's convenience with viewing angle of actual lens and heat sensor displayed



DAEMYUNG CORPORATION CO., LTD.
CS CENTER +82-31-428-9334 / 9383

website | www.webgateinc.com
blog | www.hd-cctv.co.kr

SMART HEAT DETECTION CAMERA

Heat detection / Push alarm / High-definition video / Smart search

WEBGATE
HD-CCTV solution provider

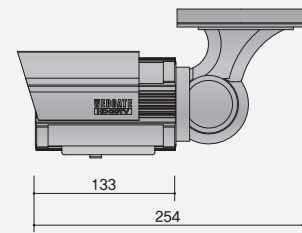
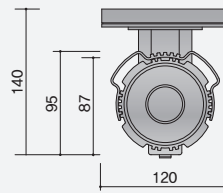

Camera type

- **PoC** Power & Control over coaxial cable
- **Non-PoC** General type
- **IP** TBD

PoC Camera

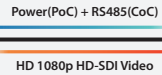

PoC DVR



| Camera Type | | PoC | Non-PoC |
|----------------------------|------------------------------|---|--|
| Model | | C1080PBL-T2 | C1080BL-T2 |
| Thermal Detection | | | |
| Thermal Detection | Sensor Type | LWIR sensor, wavelength 8 ~ 14 μm | |
| | FOV/ROI | 51° (HFOV) / 39° (VFOV) | |
| | Distance | 1~10m | |
| | Detection Temperature | 45°C~120°C | |
| | Detection Time | 3, 5, 10 Sec | |
| | Action Time | Keep On, 20, 30, 40, 50, 60 Sec | |
| | Alarm Notification | Ancillary | Ancillary and 2 wire out (Event Alarm : Low / General Alarm : Hi-Z) |
| VIDEO | | | |
| Video Sensor | | 1/3", 2.1 Megapixel Panasonic CMOS | |
| Sensor Pixels | | 1920(H) × 1080(V) = 2.1M pixels | |
| Scanning System | | Progressive Scan | |
| Min. Illumination | B/W | 0.005325Lux, DSS(x32), AGC(10), Brightness(20) | |
| | Color | 0.15Lux, DSS (x32), AGC(10) , Brightness(20) | |
| Lens | Filter | True Day & Night (ICR) | |
| | Type | f=4.0mm (F2.1) Fixed Mega Lens | |
| Video Output | Output Port | 1 (BNC 1.0 Vp-p, 75Ω) | |
| | Output | 1080p 30/25fps, 720p 30/25fps | |
| | HD-SDI / EX-SDI / EX-SDI 2.0 | SMPTE 292M compatible | |
| | Output Method | HD-SDI / EX-SDI | HD-SDI / EX-SDI / EX-SDI 2.0 |
| Camera Functions | Control Method | OSD menu, DVR (Supporting remote control via CoC), CMS (Control Center) | |
| | AGC | 1 ~ 10 steps | |
| | Mirror | Horizontal / Vertical | |
| | WDR | OFF, LOW, MIDDLE, HIGH | |
| | BLC | OFF, LOW, MIDDLE, HIGH | |
| | ACE | OFF, LOW, MIDDLE, HIGH | |
| | DNR | OFF, LOW, MIDDLE, HIGH | |
| | DSS | OFF, Auto, x2, x4, x8, x16, x32 | |
| | White Balance | AUTO, AUTOext, PRESET, MANUAL | |
| | Electric Shutter | INDOOR, OUTDOOR, INDOOR-ANTI BLUR, OUTDOOR-ANTI BLUR, MANUAL(11 steps), FLICKER | |
| | HLC | 0 ~ 20 steps | |
| | DE-FOG | OFF, AUTO, MANUAL | |
| CONTROL INTERFACE | | | |
| Control | | CoC (Control of Coax) | RS485 |
| LIGHT | | | |
| IR Light Source | | 30pcs, 850nm, 60°, control by visible light sensor, max. 25m | |
| ELECTRICITY | | | |
| Power Consumption | | PoC (DC24V ± 10%), 6W | DC12V ± 10%, 6W / AC 24V ± 10%, 7W |
| MECHANICAL | | | |
| Dimension | | 120(W) × 140(H) × 254(D) mm | |
| Weight | | Approx. 1,600g | |
| ENVIRONMENTS | | | |
| Operation Temp. / Humidity | | -10°C ~ 50°C / 0%RH ~ 80%RH | |
| CERTIFICATIONS | | | |
| Certifications | | KC, FCC, CE, RoHS | |



DAEMYUNG CORPORATION CO., LTD.
CS CENTER +82-31-428-9334 / 9383

website | www.webgateinc.com
blog | www.hd-cctv.co.kr